

Fresh water	Pool water	Sea water	220-240 V	400 V	110-120 V	50 Hz	60 Hz	12 V AC	24 V DC	DMX	DMX/RDM	Plug & Spray



### Product characteristics at glance

- 3 x energy efficient LED-RGBW-light with mounting bracket, fine adjustment and holder, for using with Multi Directional Drive XL 2D / DMX / 02
- 3 x 1707 Lumen with a beam angle of 11°, 3 x 46.5 W
- Temperature controlled high class LED
- Wet and dry installation – waterproof IP 68
- For fresh water, pool water and sea water
- External electronic in a separate control box/ junction box – waterproof connector, easy to connect
- DMX/RDM-capable in combination with the Underwater LED Driver/DMX/02
- Individual measurement of the basic colours of the LED-RGBW light and the use of the Underwater LED Driver/DMX/02 guarantees equal brightness of all lights in the system and a homogeneous colour combination
- Galvanic isolation between the DMX and 24 V/DC power
- Dimensions lamp housing: (Ø x H) 482x100 mm
- Strobe effect
- Lifetime of up to 50.000 h\*

\*In case of underwater application, an intelligent heat management and quality LED enables a lifetime of up to 50.000 hrs. This claim does not entitle to a guarantee.

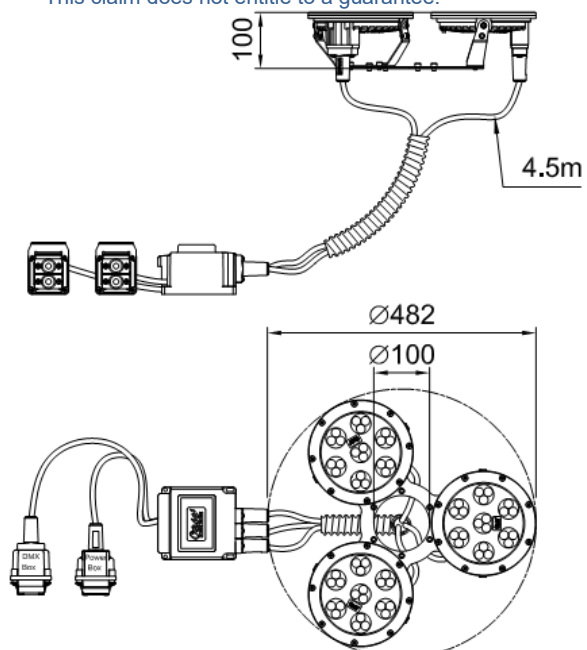

45077

### 3 x Diagram RGBW all on; 3 x 1707 lm (40m)

8.0	1.46	E(0°) E(C0)	5.2°	1494 740
16.0	2.91	E(0°) E(C0)	5.2°	373 185
24.0	4.37	E(0°) E(C0)	5.2°	166 82
32.0	5.82	E(0°) E(C0)	5.2°	93 46
40.0	7.28	E(0°) E(C0)	5.2°	60 30

Distance [m]

Cone Diameter [m]

Illuminance [lx]

— C0 - C180 (Half-value Angle: 10.4°)

45077

### 3 x Diagram red; 3 x 266 lm (40m)

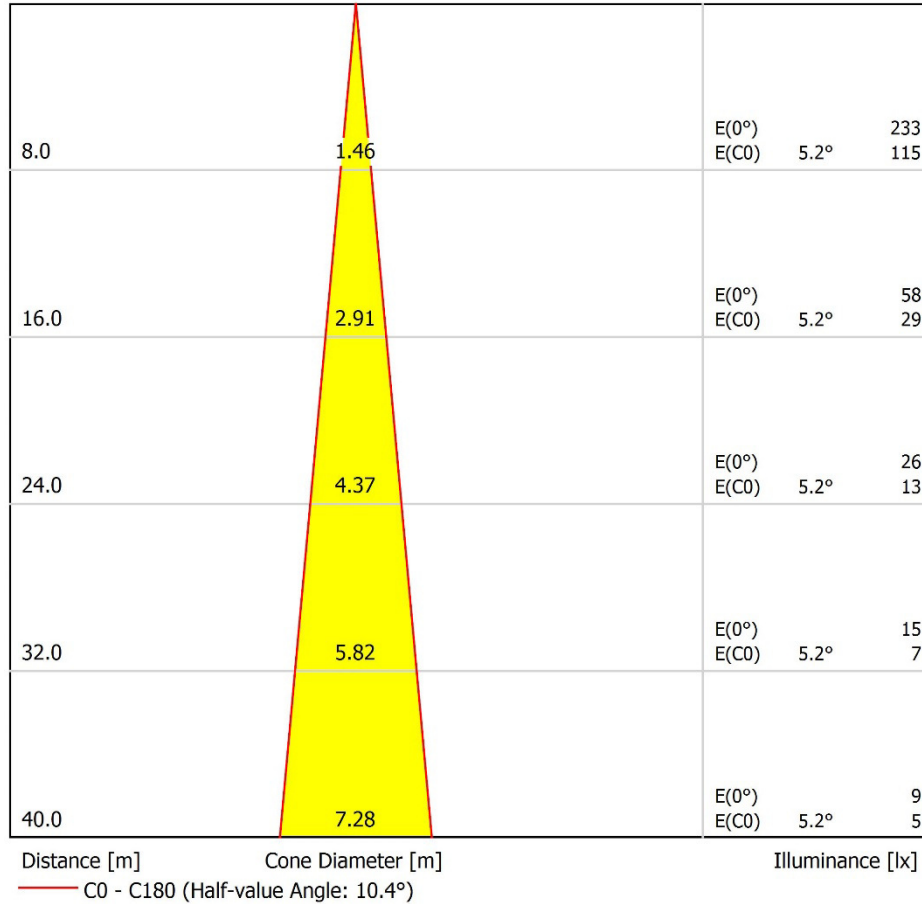

**45077**

**3 x Diagram green; 3 x 821 lm (40m)**

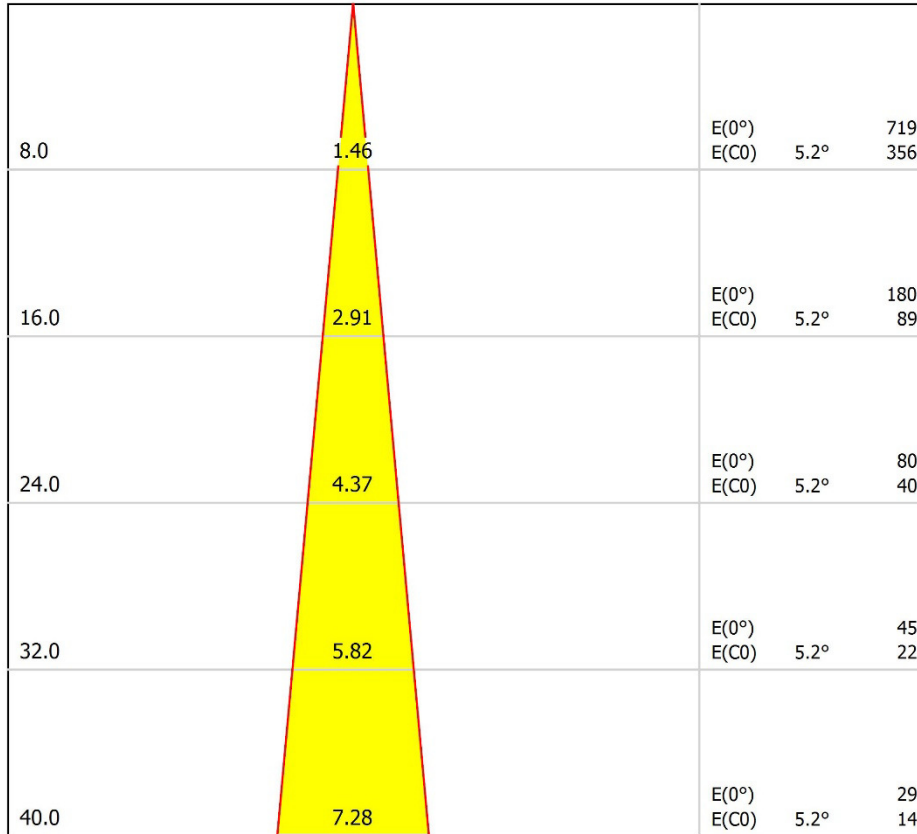

Distance [m]

Cone Diameter [m]

Illuminance [lx]

— C0 - C180 (Half-value Angle: 10.4°)

45077

### 3 x Diagram blue; 3 x 271 lm (40m)

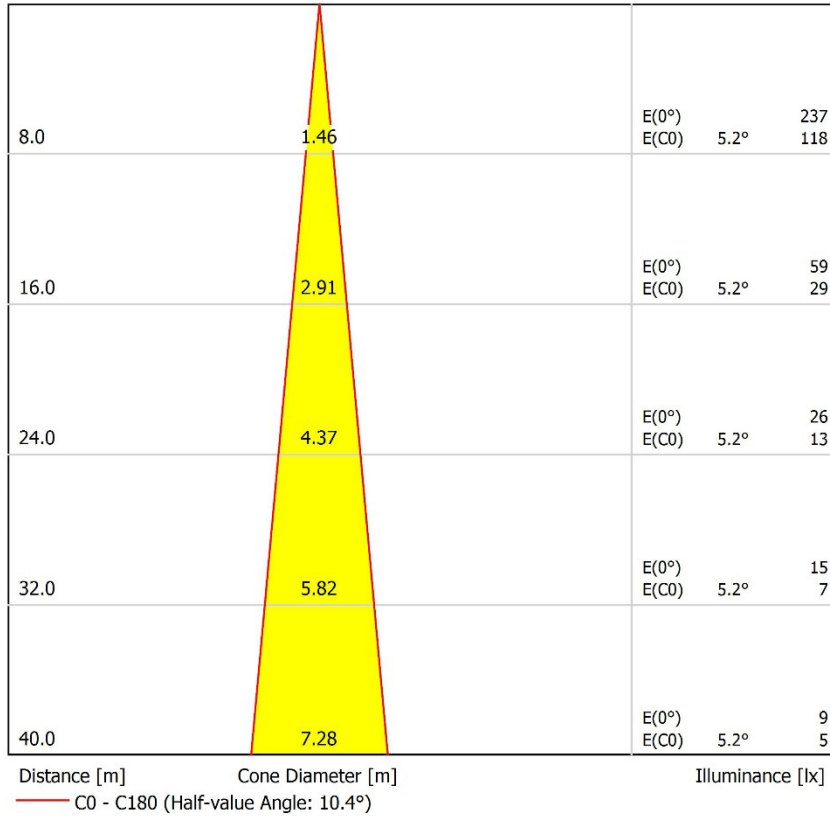

**45077**

**3 x Diagram only white; 3 x 349 lm (40m)**

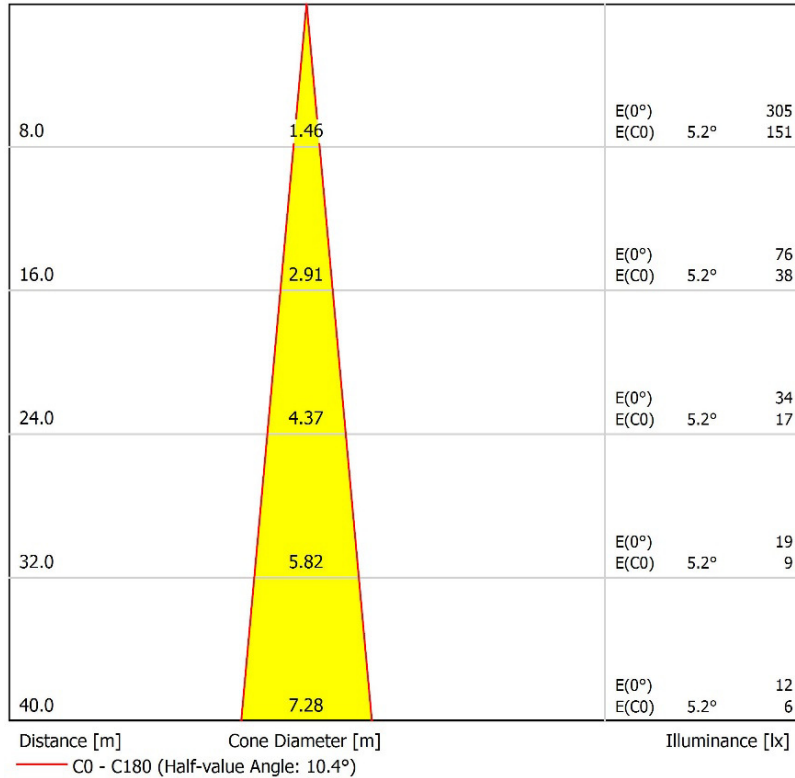

**OASE GmbH**  
 Tecklenburger Straße 161  
 D - 48477 Hörstel  
 Phone: +49(0)54 54 – 800  
 Fax: +49(0)54 54 – 80 322  
 info@oase-livingwater.com  
 www.oase-livingwater.com

## LED-Modul MDD XL 2D /DMX/02

# 45077



LED-Modul MDD XL 2D/ DMX / 02		
Luminous flux all on	lm	3 x 1707
Luminous flux red	lm	3 x 266
Luminous flux green	lm	3 x 821
Luminous flux blue	lm	3 x 271
Luminous flux white	lm	3 x 349
Colour temperature LED white	K	4000 (± 200)
Colour Rendering Index (CRI)	%	80
Beam angle	°	11 (± 2)
Strobe effect	Hz	25
Energy efficiency category		B
Weighted energy consumption per light fixture	kWh/1000h	52
Rated voltage	V/DC	24
Power consumption	W	139.5
Rated current	A	6.3
Dim frequency	Hz	2800
Power connection		1.0 m cable with box
DMX connection		1.0m cable with box
Protection class		IP 68
Dimensions (Ø x h)	mm	482 x 100
Material		stainless steel 1.4404 (AISI 316L)
Weight	kg	14.4
<b>Order no.</b>		<b>45077</b>